



Serie

S - 100

Especificaciones Técnicas

Carpintería practicable

Cámara nacional

Junta abierta con Doble Junta

Sección de Marco 40 mm.

Sección de Hoja 40 mm.

Galce de vidrio de 9,5 a 27,5 mm.

Clasificación Obtenida

Permeabilidad al aire*	CLASE 3
Estanqueidad al agua*	CLASE 6A
Resistencia al viento*	CLASE C5
Transmitancia térmica**	3,7 W(m ² K)
Aislamiento Acústico***	31 (-1;-4)dB

* Ventana de 2 hojas de 1230 x 1480 mm .

** Ventana de 2 hojas de 1480 x 2180 mm . con cajón de persiana ; Vidrio 4-10-4

*** Ventana de 2 hojas de 1230 x 1480 mm ; Vidrio 4-10-4

Posibilidades de Apertura

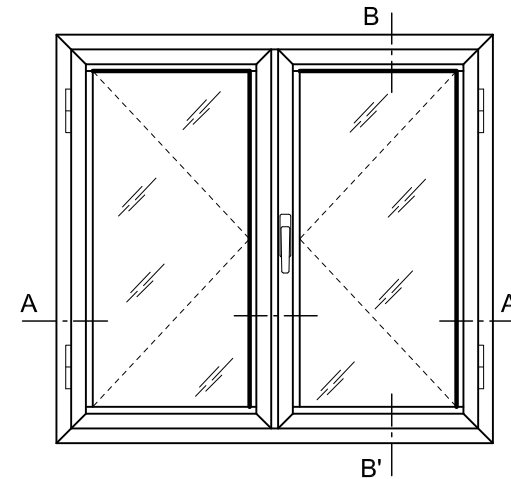
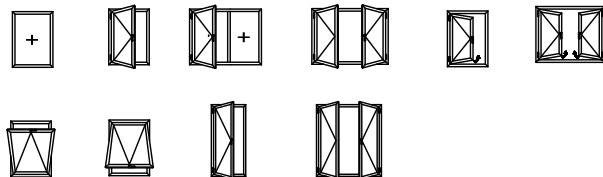

VENTANA 2 HOJAS PRACTICABLES

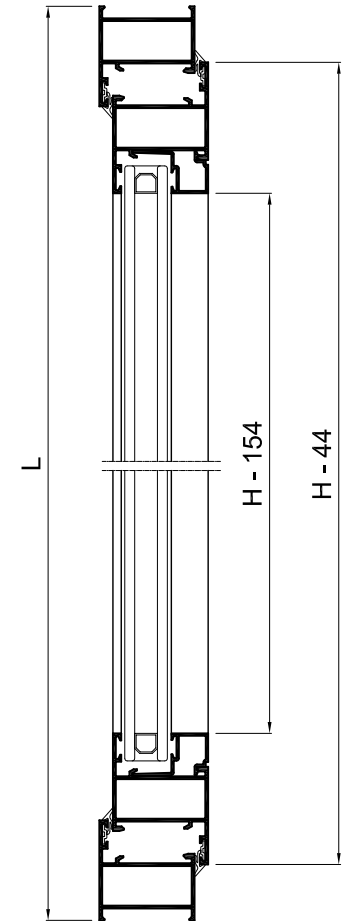

Sección B-B'

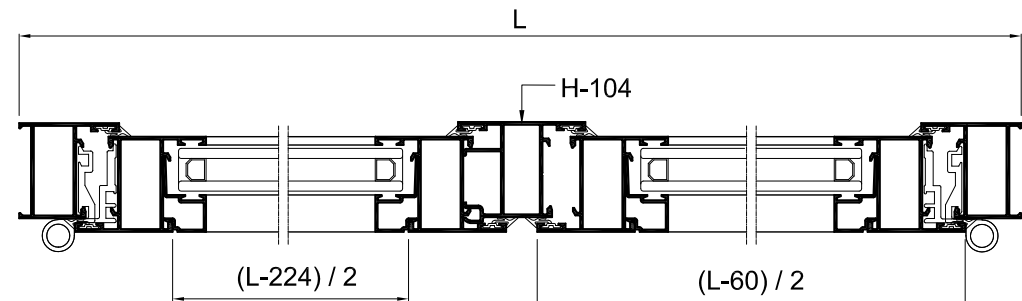

Sección A-A'

Perfiles

S - 100

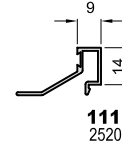
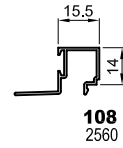
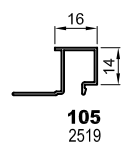
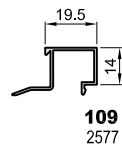
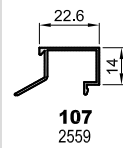
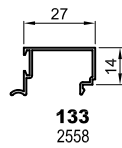
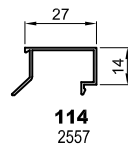
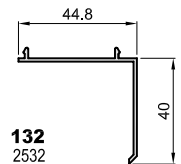
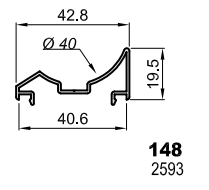
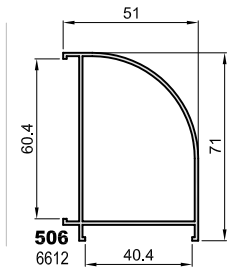
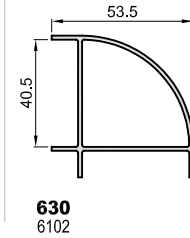
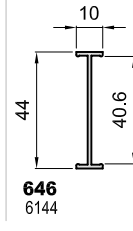
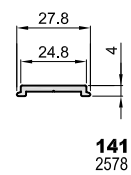
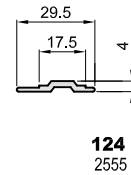
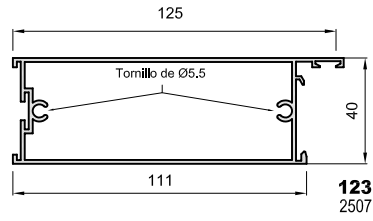
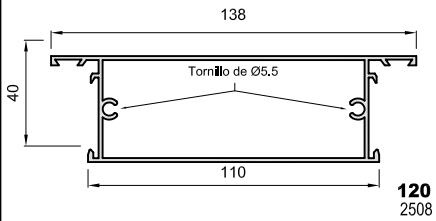
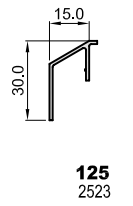
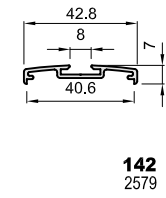
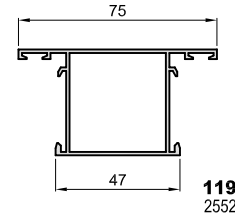
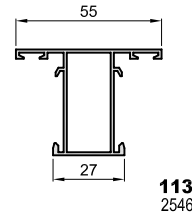
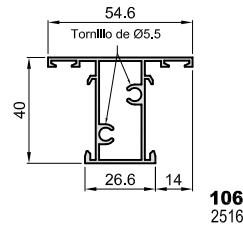
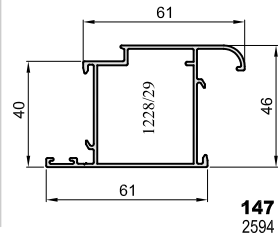
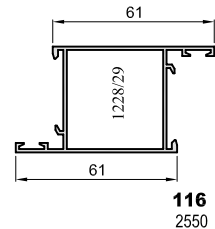
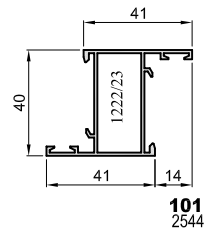
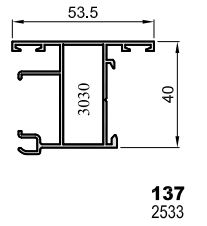
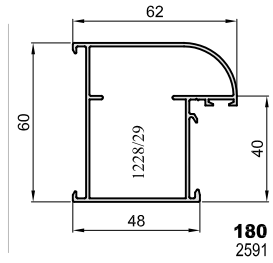
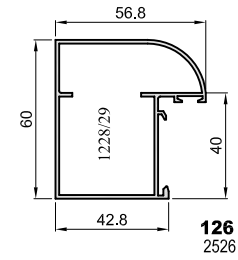
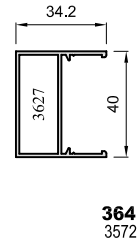
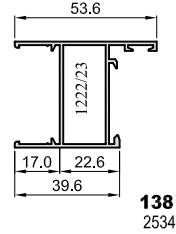
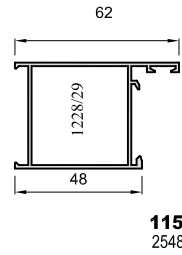
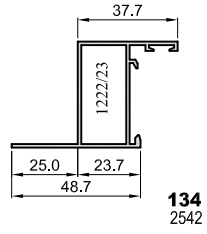
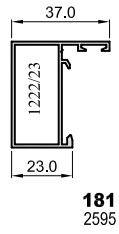
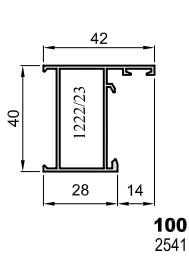



Accesorios

S - 100



1032
Cremona giro
Alugom

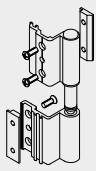

1009
Bisagra
deslizante
c/regleta



3008
Goma pernio
deslizante S-100



3030
Tapa inversora
S-100 (113)



1222
Escuadra S-100
40x20 T.Centr.



1228
Escuadra S-100
40x40 T. Centr.



1223
Escuadra S-100
40x20
T.Desentr.



1229
Escuadra S-100
40x40 T.
Descentr.



1215
Tocho S-100
40 x 20



1216
Tocho S-100
40 x 40



1048
Kit Cremona
S-100



1060
Pasador plano
ancho nylon



4337
Embelle. salida
agua c/membrana

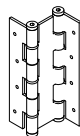

1007
Bisagra vaiven

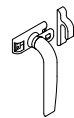

1044
Cierre presión
grande

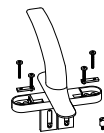

1033
Cremona Patillas
Apert. Externa

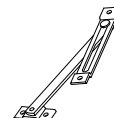

1006
Bisagra compás

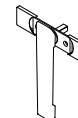

4282
Manilla extraplana
super



1056
Pasador 50
mm.



1057
Pasador 100
mm.



2040
Cepillo Vaiven
14 x 12

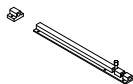

1058
Pasador 200
mm.

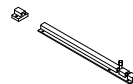

1059
Pasador 300
mm.

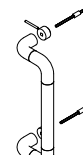

1076
Juego tirador
Style



1224
Escuadra
ang.variable

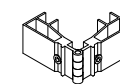

1225
Escuadra ang.
variable Portada

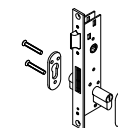

1510
Cerradura de
gancho c/resb.

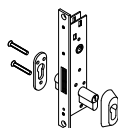

1511
Cerradura de
gancho s/resb.



1520
Cerradero
grande



1521
Cerradero
pequeño 210

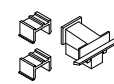

3032
Tapa inversora
s-350 (137)



3017
Junta S-100 y
S-350

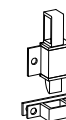

1031
Cierre golpete

